

FANUC Robot SR series

FEATURES

FANUC Robot SR-3*i*A, 6*i*A, 12*i*A, 20*i*A is SCARA robot whose payload is 3 to 20kg.

- Nine models are available to meet a variety of payload, motion range and installation requirements.
- A lightweight arm and the most advanced servo technology enables superior accuracy and high duty performance, which improves productivity.
- The SR-3*i*A and 6*i*A offer food grade options. The SR-12*i*A and 20*i*A offer environmental options including white epoxy coating, bellow covers, anti-rust bolts and seals, and IP65 rating to withstand dust and liquids.
- Internal cable routing in the J2 arm eliminates interference, and the hollow arm on the J4 rotation axis allows easy gripper installation.
- SR-3*i*A/U is a ceiling mount type robot. It can use its full 360° envelope to maximize work space, even in limited areas.
- The R-30*i*B Compact Plus controller is significantly smaller than previous controllers with the same functionality and power.
- Easy to use and intuitive robot setup and programming on a PC or Tablet
- Latest intelligent functions are available, such as *i*RVision (integrated vision) and *i*RPickTool.

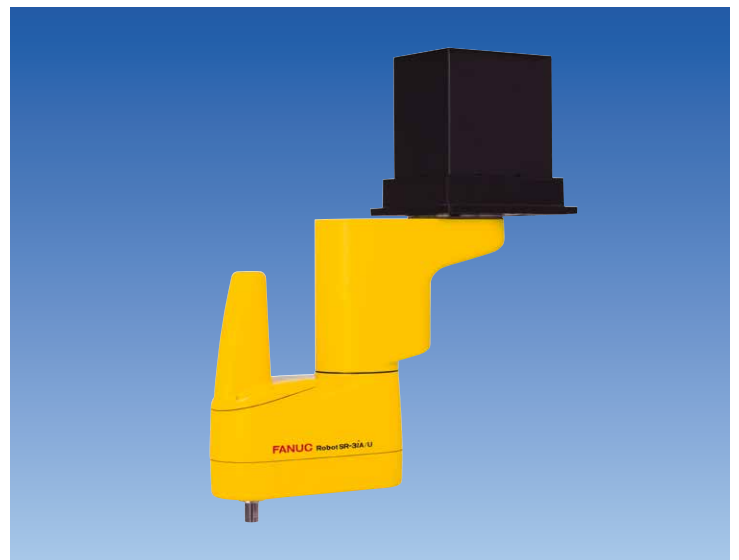

SR-3*i*A/U

Operating Space

SR-3iA
SR-3iA/C
SR-3iA/H

SR-6iA
SR-6iA/C
SR-6iA/H

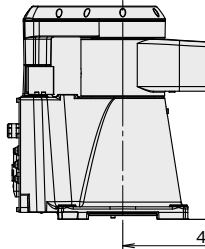
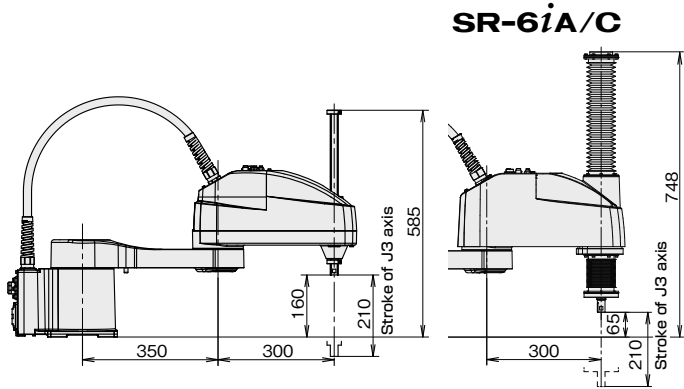
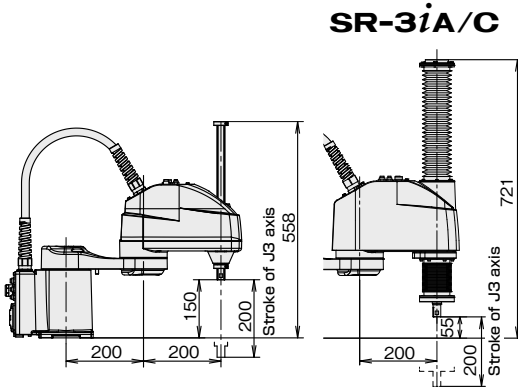
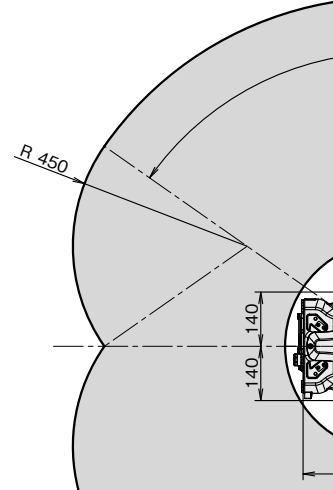
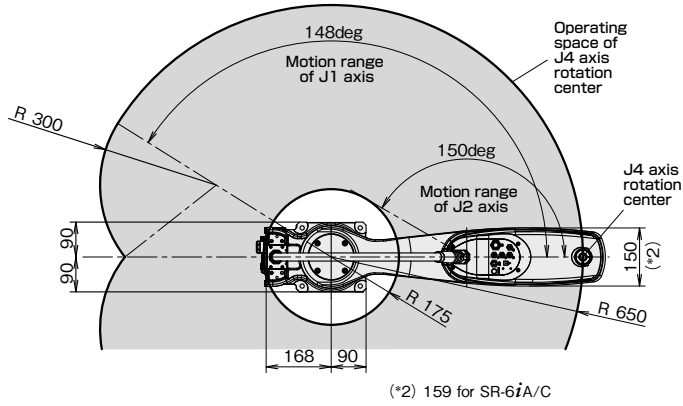
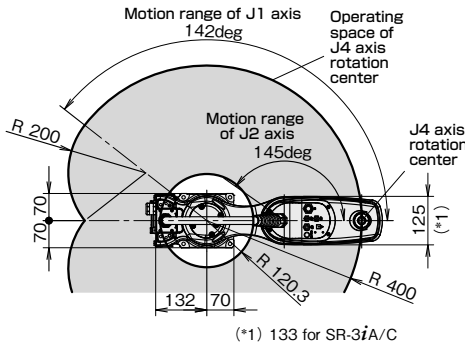

SR-3iA/U

Specifications

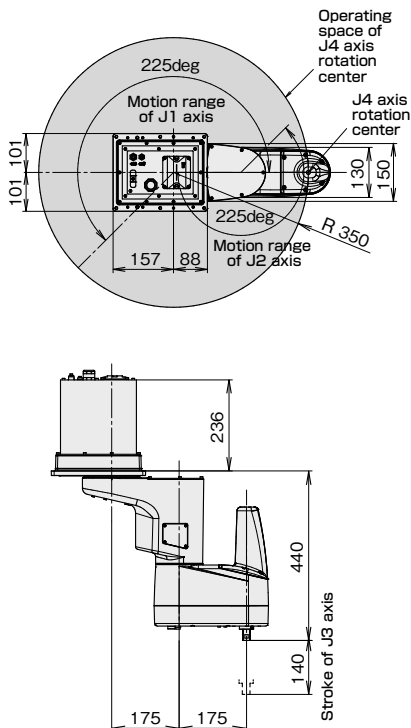

Model		SR-3iA/U	SR-3iA	SR-3iA/H
Type				
Controlled axes		4 axes (J1, J2, J3, J4)		
Reach		350 mm		400
Installation		Ceiling		
Motion range (Maximum speed) (Note 1)	J1 axis	± 225deg (610deg/s) ± 3.93 rad (10.65 rad/s)		± 142deg (400deg/s) ± 2.48 rad (7.14 rad/s)
	J2 axis	± 225deg (840deg/s) ± 3.93 rad (14.66 rad/s)		± 145deg (400deg/s) ± 2.53 rad (7.14 rad/s)
	J3 stroke	140 mm (1500 mm/s)		200 mm (1800 mm/s)
	J4 axis		± 720deg (3000deg/s) ± 12.57 rad (52.36 rad/s)	3 kg
Max. load capacity at wrist				
Allowable load inertia at wrist		J4 axis	0.06 kg·m ²	
Repeatability	J1 + J2 axis			
	J3 axis			
	J4 axis	± 0.004deg		
J3 axis maximum push down force (Note 2)		150 N		
Cables and air for user		Standard Option		
Mass (Note 3)		27 kg	19 kg	21 kg
Installation environment		Ambient temperature: 0 to 40°C Ambient humidity: 20 to 80% Vibration: 0.1 to 0.5 mm/s		
Matching controller R-30iB Compact Plus	Rated Voltage			
	Mass of controller			
	Dimensions (W×D×H)			
	Degree of protection			

Note 1) In case of short distance motion, the axis speed may not reach the maximum value stated.
 Note 2) Alarms may be occurred if push down for a long time.
 Note 3) Without controller.

SR-12iA

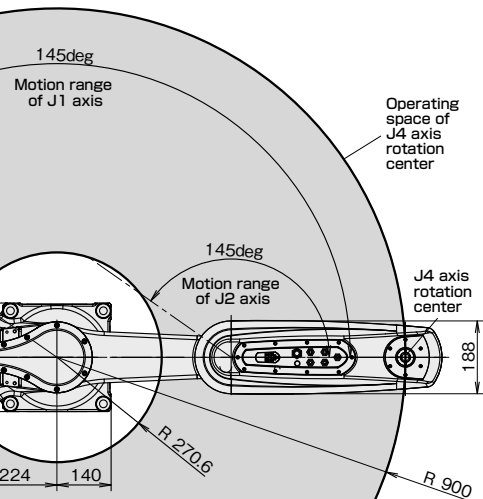

SR-20iA

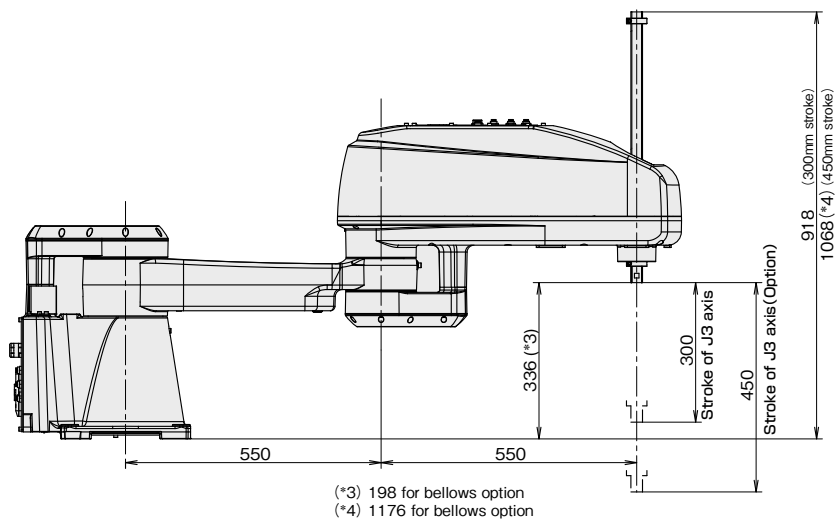
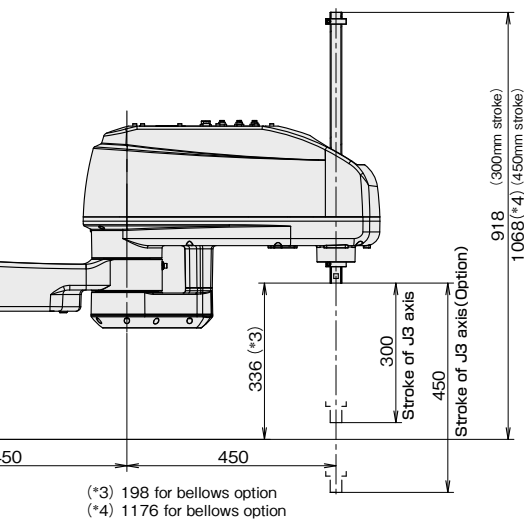
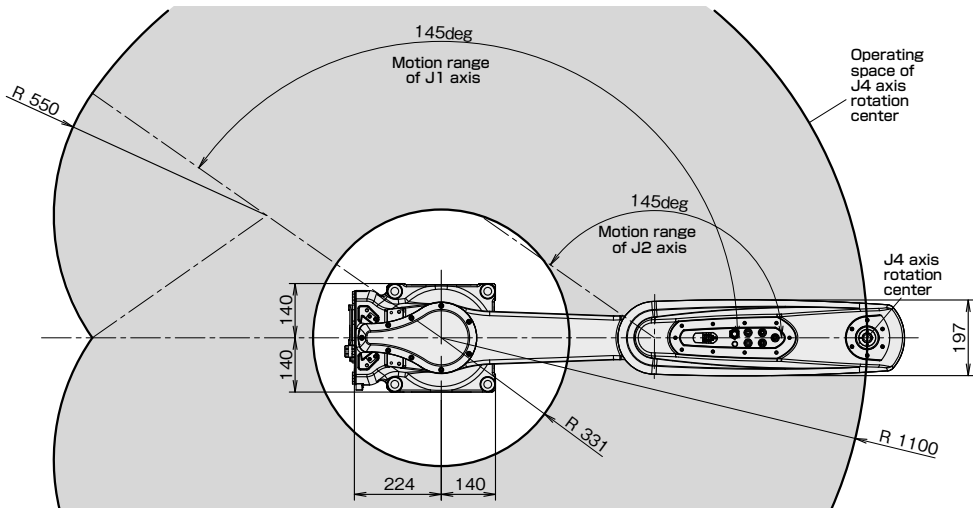

Model	SR-3iA/H	SR-6iA	SR-6iA/C	SR-6iA/H	SR-12iA	SR-20iA
Type	SCARA Type					
Axes	3 axes (J1, J2, J3)	4 axes (J1, J2, J3, J4)		3 axes (J1, J2, J3)	4 axes (J1, J2, J3, J4)	
Width		650 mm			900 mm	1100 mm
Speed		± 148deg (440deg/s) ± 2.58 rad (7.68 rad/s)			± 145deg (440deg/s) ± 2.53 rad (7.68 rad/s)	
Speed		± 150deg (700deg/s) ± 2.62 rad (12.22 rad/s)			± 145deg (510deg/s) ± 2.53 rad (8.90 rad/s)	± 145deg (500deg/s) ± 2.53 rad (8.73 rad/s)
Stroke		210 mm (2000 mm/s)			300 mm (2800 mm/s) 450 mm (Option) (2800 mm/s)	
Speed		± 720deg (2500deg/s) ± 12.57 rad (43.63 rad/s)			± 720deg (2500deg/s) ± 12.57 rad (43.63 rad/s)	± 720deg (1700deg/s) ± 12.57 rad (29.67 rad/s)
Weight		6 kg			12 kg	20 kg
Weight		0.12 kg·m ²			0.30 kg·m ²	0.45 kg·m ²
Positioning Accuracy	± 0.01 mm				± 0.02 mm	
Repeatability	± 0.01 mm				± 0.005deg	
Force		± 0.004deg			250 N	
Force		200 N			250 N	
Ports	RI × 4 / RO × 4, Φ6 mm × 1, Φ4 mm × 2				RI × 4 / RO × 4, Φ6 mm × 3	
Ports	RI × 4, Φ6 mm × 1, Solenoid valve × 2					
Weight	17 kg	30 kg	32 kg	28 kg	53 kg	64 kg
Operating temperature	0 to 45°C					
Operating humidity	Normally 75%RH or less (No dew nor frost allowed) Short term (within one month) 95%RH or less (No dew nor frost allowed)					
Acceleration	4.9m/s ² (0.5G) or less					
Power	AC 200-240V Single phase +10% - 15%, 50/60Hz ± 1Hz					
Weight	9 kg					
Dimensions	440 × 260 × 85.5 mm					
Protection	Conforming to IP20					

Application Examples

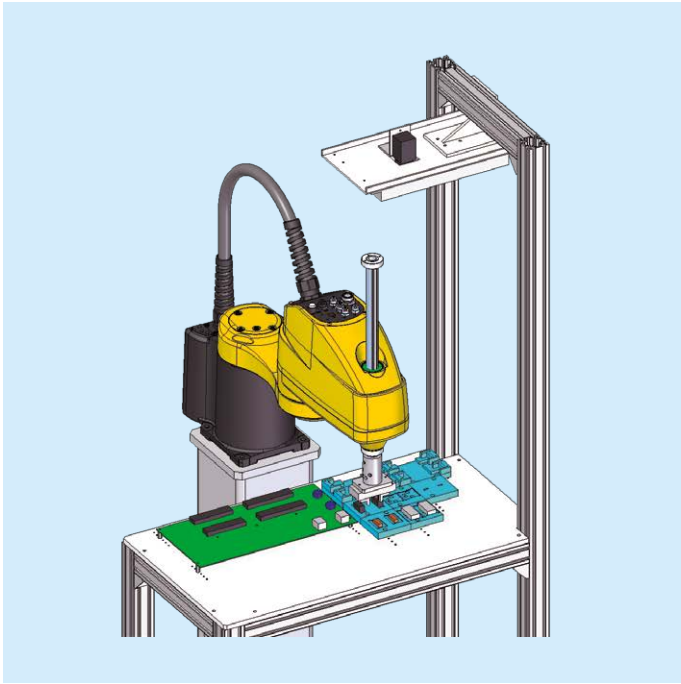

Circuit board assembly by SR-3iA

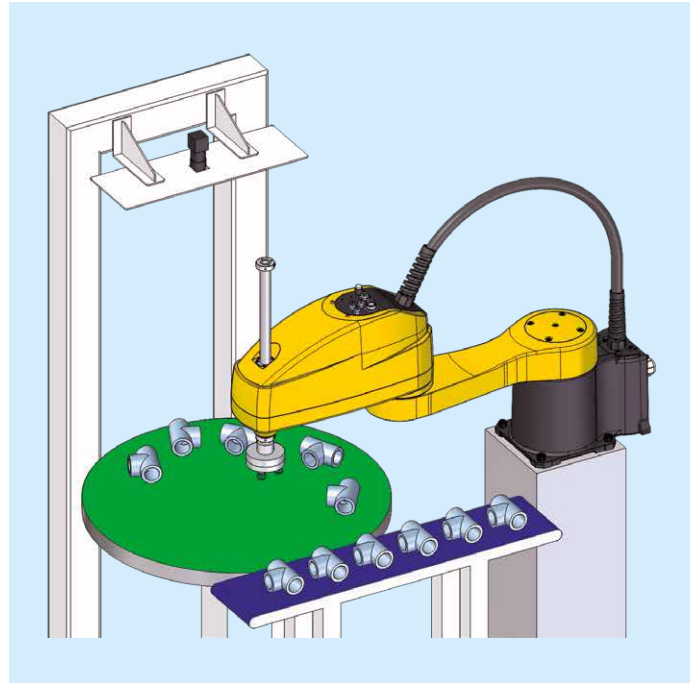

Visual circular tracking by SR-6iA

Option



SR-12iA water proof

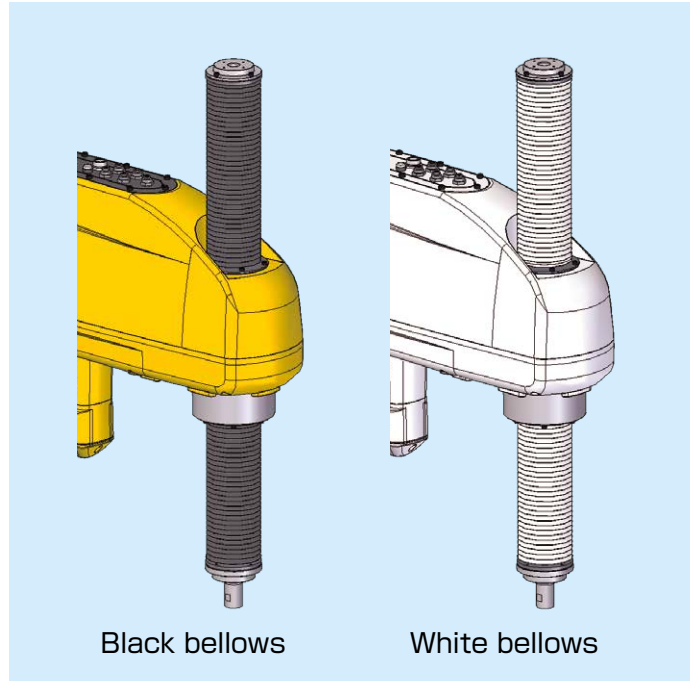

Black bellows

White bellows

Example of bellows option

FANUC CORPORATION

- Overseas Affiliated Companies
- FANUC America Corporation
- FANUC Europe Corporation, S.A.
- SHANGHAI-FANUC Robotics CO., LTD.
- KOREA FANUC CORPORATION
- TAIWAN FANUC CORPORATION
- FANUC INDIA PRIVATE LIMITED
- FANUC SINGAPORE PTE. LTD.
- FANUC THAI LIMITED
- FANUC MECHATRONICS (MALAYSIA) SDN. BHD.
- PT. FANUC INDONESIA
- FANUC OCEANIA PTY. LIMITED
- FANUC SOUTH AFRICA (PROPRIETARY) LIMITED

Phone: (+1)248-377-7000
 Phone: (+352)727777-1
 Phone: (+86)21-5032-7700
 Phone: (+82)55-278-1200
 Phone: (+886)4-2359-0522
 Phone: (+91)80-2852-0057
 Phone: (+65)6567-8566
 Phone: (+66)2-714-6111
 Phone: (+60)3-3082-1222
 Phone: (+62)21-4584-7285
 Phone: (+61)2-8822-4600
 Phone: (+27)11-392-3610

<https://www.fanucamerica.com/>
<https://www.fanuc.eu/>
<https://www.shanghai-fanuc.com.cn/>
<https://www.fkc.co.kr/>
<https://www.fanuctaiwan.com.tw/>
<https://www.fanucindia.com/>
<https://www.fanuc.com/fsp/>
<https://www.fanuc.com/fth/>
<https://www.fanuc.com/fmm/>
<https://www.fanuc.com/fin/>
<https://www.fanucoceania.com.au/>
<https://fanuc.co.za/>

- Headquarters 3580, Shibokusa, Oshino-mura, Minamitsuru-gun Yamanashi, 401-0597, JAPAN
- Phone: (+81)555-84-5555 <https://www.fanuc.co.jp/>

- All specifications are subject to change without notice.
- No part of this catalog may be reproduced in any form.
- The products in this catalog are controlled based on Japan's "Foreign Exchange and Foreign Trade Law". The export from Japan may be subject to an export license by the government of Japan. Further, re-export to another country may be subject to the license of the government of the country from where the product is re-exported. Furthermore, the product may also be controlled by re-export regulations of the United States government. Should you wish to export or re-export these products, please contact FANUC for advice.